

RSMMeans[®] Square Foot Costs

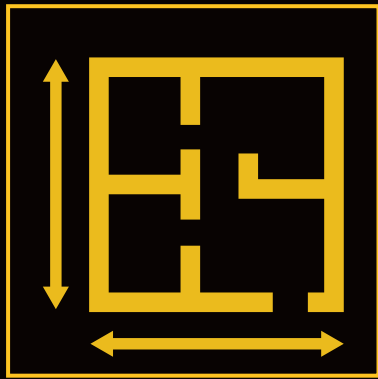

Designed to provide reliable, early estimates of building costs

2014

35th annual edition

Cost data from the most quoted name in construction

The 2014 *Square Foot Costs*, 35th annual edition, and all of the RSMMeans annual cost data books for 2014, are dedicated to the memory of our respected colleague and friend, Paula Reale-Camelio.

RSMMeans[®] Square Foot Costs

35TH ANNUAL EDITION

2014

RSMMeans

A division of Reed Construction Data, LLC
Construction Publishers & Consultants
700 Longwater Drive
Norwell, MA 02061
USA

1-800-334-3509
www.rsmeans.com

Copyright 2013 by RSMMeans
A division of Reed Construction Data, LLC
All rights reserved.

Printed in the United States of America
ISSN 1540-6326
ISBN 978-1-940238-44-9

The authors, editors, and engineers of RSMMeans apply diligence and judgment in locating and using reliable sources for the information published. However, RSMMeans makes no express or implied warranty or guarantee in connection with the content of the information contained herein, including the accuracy, correctness, value, sufficiency, or completeness of the data, methods, and other information contained herein. RSMMeans makes no express or implied warranty of merchantability or fitness for a particular purpose. RSMMeans shall have no liability to any customer or third party for any loss, expense, or damage, including consequential, incidental, special, or punitive damage, including lost profits or lost revenue, caused directly or indirectly by any error or omission, or arising out of, or in connection with, the information contained herein.

No part of this publication may be reproduced, stored in a retrieval system, or transmitted in any form or by any means without prior written permission of RSMMeans. The cost data contained in this publication is valuable and proprietary information of RSMMeans and others and there is no transfer to you of any ownership rights in the cost data or any license granted to you to create derivative works based on or which utilize the cost data.

Senior Editor

Marilyn Phelan, AIA (9, 10, 11, 12)*

Contributing Editors

Christopher Babbitt

Adrian C. Charest, PE (26, 27, 28, 48)

Gary W. Christensen

David G. Drain, PE (33)

Cheryl Elsmore

David Fiske

Robert Fortier, PE (2, 31, 32, 34, 35, 46)

Robert J. Kuchta (8)

Thomas Lane

Robert C. McNichols

Genevieve Medeiros

Melville J. Mossman, PE (21, 22, 23)

Jeannene D. Murphy

Stephen C. Plotner (3, 5)

Siobhan Soucie

Phillip R. Waier, PE (1, 13)

Cover Design

Wendy McBay

Paul Robertson

Wayne Engebretson

Chief Operating Officer

Richard Remington

Vice President, Business Development

Steven Ritchie

Vice President, Finance & Operations

Renée Pinczes

Senior Director, Inside Sales

Derek F. Dean

Sales Manager

Reid Clanton

Director, Engineering

Bob Mewis, CCC (4, 6, 7, 14, 41, 44)

Senior Director, Product Management

Jennifer Johnson

Senior Product Marketing Manager

Andrea Sillah

Senior Director, Operations

Rodney L. Sharples

Production Manager

Michael Kokernak

Production

Jill Goodman

Jonathan Forgit

Debbie Panarelli

Sara Rutan

Mary Lou Geary

Technical Support

Christopher Anderson

Gary L. Hoitt

Kathryn S. Rodriguez

*Numbers in italics are the divisional responsibilities for each editor.
Please contact the designated editor directly with any questions.

Table of Contents

Foreword	iv	Assemblies	285
How the Book Is Built: An Overview	v	Introduction	289
Residential Models	1	How to Use	290
Introduction	3	Example	294
How to Use	4	Substructure	303
Worksheets	13	Shell	311
Example	15	Interiors	395
Economy	18	Services	419
Average	26	Equipment & Furnishings	491
Custom	38	Special Construction	501
Luxury	48	Building Sitework	507
Adjustments	58	References	517
Commercial/Industrial/Institutional Models	65	General Conditions	518
Introduction	67	Location Factors	519
How to Use	68	Historical Cost Indexes	525
Examples	73	Square Foot Costs	533
Building Types	78	Glossary	542
Depreciation	232	Abbreviations	546
Green Commercial/Industrial/Institutional Models	233	Estimating Forms	550
Building Types	234	Other RSMeans Products and Services	571
		Labor Trade Rates including Overhead & Profit	Inside Back Cover

Residential Section

Table of Contents

	<i>Page</i>		<i>Page</i>		<i>Page</i>
Introduction		Economy		Luxury	
General	3	Illustrations	18	Illustrations	48
How to Use.....	4	Specifications	19	Specifications	49
Building Classes	6	1 Story.....	20	1 Story.....	50
Configurations.....	7	1-1/2 Story	21	1-1/2 Story	51
Building Types.....	8	2 Story.....	22	2 Story.....	52
Garage Types	10	Bi-Level.....	23	2-1/2 Story	53
Building Components	11	Tri-Level	24	3 Story.....	54
Exterior Wall Construction	12	Wings & Ells.....	25	Bi-Level	55
Residential Cost Estimate Worksheets		Average		Tri-Level	56
Instructions	13	Illustrations	26	Wings & Ells.....	57
Model Residence Example.....	15	Specifications	27	Residential Modifications	
		1 Story.....	28	Kitchen Cabinets.....	58
		1-1/2 Story	29	Kitchen Countertops.....	58
		2 Story.....	30	Vanity Bases.....	59
		2-1/2 Story	31	Solid Surface Vanity Tops.....	59
		3 Story.....	32	Fireplaces & Chimneys.....	59
		Bi-Level.....	33	Windows & Skylights	59
		Tri-Level	34	Dormers	59
		Solid Wall (log home) 1 Story	35	Appliances	60
		Solid Wall (log home) 2 Story	36	Breezeway	60
		Wings & Ells.....	37	Porches.....	60
		Custom		Finished Attic.....	60
		Illustrations	38	Alarm System.....	60
		Specifications	39	Sauna, Prefabricated.....	60
		1 Story.....	40	Garages	61
		1-1/2 Story	41	Swimming Pools	61
		2 Story.....	42	Wood & Coal Stoves	61
		2-1/2 Story	43	Sidewalks.....	61
		3 Story.....	44	Fencing.....	61
		Bi-Level.....	45	Carport.....	61
		Tri-Level	46	Insurance Exclusions	62
		Wings & Ells.....	47	Architect/Designer Fees	62
				Depreciation.....	63

Commercial/Industrial/ Institutional Models

Table of Contents

<i>Table No.</i>	<i>Page</i>	<i>Table No.</i>	<i>Page</i>	<i>Table No.</i>	<i>Page</i>
Introduction					
General	67	M.195 Day Care Center	120	M.460 Office, 2-4 Story	176
How To Use	68	M.200 Factory, 1 Story	122	M.470 Office, 5-10 Story	178
Examples		M.210 Factory, 3 Story	124	M.480 Office, 11-20 Story	180
Example 1	73	M.220 Fire Station, 1 Story	126	M.485 Outpatient Surgery Center	182
Example 2	75	M.230 Fire Station, 2 Story	128	M.490 Police Station	184
Standard Models		M.240 Fraternity/Sorority House	130	M.495 Post Frame Barn	186
Building Types		M.250 Funeral Home	132	M.500 Post Office	188
M.010 Apartment, 1-3 Story	78	M.260 Garage, Auto Sales	134	M.510 Racquetball Court	190
M.020 Apartment, 4-7 Story	80	M.270 Garage, Parking	136	M.520 Religious Education	192
M.030 Apartment, 8-24 Story	82	M.280 Garage, Underground Parking	138	M.530 Restaurant	194
M.035 Assisted - Senior Living	84	M.290 Garage, Repair	140	M.540 Restaurant, Fast Food	196
M.040 Auditorium	86	M.300 Garage, Service Station	142	M.550 Rink, Hockey/Indoor Soccer	198
M.050 Bank	88	M.310 Gymnasium	144	M.560 School, Elementary	200
M.060 Bowling Alley	90	M.320 Hangar, Aircraft	146	M.570 School, High, 2-3 Story	202
M.070 Bus Terminal	92	M.330 Hospital, 2-3 Story	148	M.580 School, Jr. High, 2-3 Story	204
M.080 Car Wash	94	M.340 Hospital, 4-8 Story	150	M.590 School, Vocational	206
M.090 Church	96	M.350 Hotel, 4-7 Story	152	M.600 Store, Convenience	208
M.100 Club, Country	98	M.360 Hotel, 8-24 Story	154	M.610 Store, Department, 1 Story	210
M.110 Club, Social	100	M.370 Jail	156	M.620 Store, Department, 3 Story	212
M.120 College, Classroom, 2-3 Story	102	M.380 Laundromat	158	M.630 Store, Retail	214
M.130 College, Dorm., 2-3 Story	104	M.390 Library	160	M.640 Supermarket	216
M.140 College, Dorm., 4-8 Story	106	M.400 Medical Office, 1 Story	162	M.650 Swimming Pool, Enclosed	218
M.150 College, Laboratory	108	M.410 Medical Office, 2 Story	164	M.660 Telephone Exchange	220
M.160 College, Student Union	110	M.420 Motel, 1 Story	166	M.670 Town Hall, 1 Story	222
M.170 Community Center	112	M.430 Motel, 2-3 Story	168	M.680 Town Hall, 2-3 Story	224
M.175 Computer Data Center	114	M.440 Movie Theatre	170	M.685 Veterinary Hospital	226
M.180 Courthouse, 1 Story	116	M.450 Nursing Home	172	M.690 Warehouse	228
M.190 Courthouse, 2-3 Story	118	M.455 Office, 1 Story	174	M.700 Warehouse, Self Storage	230
				Depreciation	232

Green Commercial/Industrial/ Institutional Section

Table of Contents

<i>Table No.</i>	<i>Page</i>	<i>Table No.</i>	<i>Page</i>	<i>Table No.</i>	<i>Page</i>
Green Models					
G.050 Bank	234	G.390 Library	250	G.530 Restaurant	270
G.120 College, Classroom, 2-3 Story	236	G.400 Medical Office, 1 Story	252	G.560 School, Elementary	272
G.130 College, Dorm., 2-3 Story	238	G.410 Medical Office, 2 Story	254	G.570 School, High, 2-3 Story	274
G.140 College, Dorm., 4-8 Story	240	G.420 Motel, 1 Story	256	G.580 School, Jr. High, 2-3 Story	276
G.150 College, Laboratory	242	G.430 Motel, 2-3 Story	258	G.590 School, Vocational	278
G.220 Fire Station, 1 Story	244	G.455 Office, 1 Story	260	G.640 Supermarket	280
G.230 Fire Station, 2 Story	246	G.460 Office, 2-4 Story	262	G.690 Warehouse	282
G.250 Funeral Home	248	G.470 Office, 5-10 Story	264		
		G.480 Office, 11-20 Story	266		
		G.490 Police Station	268		

Assemblies Section

Table of Contents

Table No.	Page
A SUBSTRUCTURE	
A1010 Standard Foundations	
A1010 110 Strip Footings	304
A1010 210 Spread Footings	305
A1010 320 Foundation Dampproofing	305
A1030 Slab on Grade	
A1030 120 Plain & Reinforced	307
A2010 Basement Excavation	
A2010 110 Building Excavation & Backfill	308
A2020 Basement Walls	
A2020 110 Walls, Cast in Place	309
B SHELL	
B1010 Floor Construction	
B1010 203 C.I.P. Column, Square Tied	312
B1010 204 C.I.P. Column, Square Tied-Minimum Reinforcing	313
B1010 206 Tied, Concentric Loaded Precast Concrete Columns	314
B1010 207 Tied, Eccentric Loaded Precast Concrete Columns	314
B1010 208 Steel Columns	315
B1010 210 Wood Columns	318
B1010 214 "T" Shaped Precast Beams	319
B1010 215 "L" Shaped Precast Beams	319
B1010 217 Cast in Place Slabs, One Way	320
B1010 219 Cast in Place Beam & Slab, One Way	320
B1010 220 Cast in Place Beam & Slab, Two Way	321
B1010 222 Cast in Place Flat Slab with Drop Panels	321
B1010 223 Cast in Place Flat Plate	322
B1010 226 Cast in Place Multispan Joist Slab	322
B1010 227 Cast in Place Waffle Slab	323
B1010 229 Precast Plank with No Topping	324
B1010 230 Precast Plank with 2" Concrete Topping	324
B1010 234 Precast Double "T" Beams with No Topping	325
B1010 235 Precast Double "T" Beams With 2" Topping	325
B1010 236 Precast Beam & Plank with No Topping	326
B1010 238 Precast Beam & Plank with 2" Topping	326
B1010 239 Precast Double "T" & 2" Topping on Precast Beams	327
B1010 241 W Shape Beams & Girders	328
B1010 244 Light Gauge Steel Floor Systems	329
B1010 246 Deck & Joists on Bearing Walls	330
B1010 248 Steel Joists on Beam & Wall	331
B1010 250 Steel Joists, Beams & Slab on Columns	333
B1010 252 Composite Beam & Cast in Place Slab	335
B1010 254 W Shape, Composite Deck, & Slab	336
B1010 256 Composite Beams, Deck & Slab	337
B1010 258 Metal Deck/Concrete Fill	338
B1010 261 Wood Joist	338
B1010 264 Wood Beam & Joist	338
B1010 720 Steel Column Fireproofing	339

Table No.	Page
B1020 Roof Construction	
B1020 102 Wood/Flat or Pitched	340
B1020 108 Steel Joists, Beams & Deck on Columns & Walls	341
B1020 112 Steel Joists, Beams, & Deck on Columns	342
B1020 116 Steel Joists & Deck on Bearing Walls	343
B1020 120 Steel Joists, Joist Girders & Deck on Columns & Walls	344
B1020 124 Steel Joists & Joist Girders on Columns	345
B2010 Exterior Walls	
B2010 101 Cast In Place Concrete	346
B2010 102 Flat Precast Concrete	346
B2010 103 Fluted Window or Mullion Precast Concrete	347
B2010 104 Ribbed Precast Concrete	348
B2010 105 Precast Concrete Specialties	349
B2010 106 Tilt-Up Concrete Panel	350
B2010 109 Concrete Block Wall - Regular Weight	351
B2010 110 Concrete Block Wall - Lightweight	351
B2010 111 Reinforced Concrete Block Wall - Regular Weight	352
B2010 112 Reinforced Concrete Block Wall - Lightweight	352
B2010 113 Split Ribbed Block Wall - Regular Weight	354
B2010 115 Reinforced Split Ribbed Block Wall - Regular Weight	354
B2010 117 Split Face Block Wall - Regular Weight	356
B2010 119 Reinforced Split Face Block Wall - Regular Weight	357
B2010 125 Solid Brick Walls - Single Wythe	358
B2010 126 Solid Brick Walls - Double Wythe	359
B2010 127 Reinforced Brick Walls	359
B2010 128 Stone Veneer	361
B2010 129 Brick Veneer/Wood Stud Backup	363
B2010 130 Brick Veneer/Metal Stud Backup	363
B2010 132 Brick Face Composite Wall - Double Wythe	365
B2010 133 Brick Face Composite Wall - Triple Wythe	367
B2010 134 Brick Face Cavity Wall	368
B2010 135 Brick Face Cavity Wall - Insulated Backup	370
B2010 140 Glass Block	372
B2010 146 Metal Siding Panel	373
B2010 148 Panel, Shingle & Lap Siding	374
B2010 151 Stucco Wall	376
B2010 152 E.I.F.S.	376
B2010 154 Metal Siding Support	378
B2010 160 Pole Barn Exterior Wall	379
B2020 Exterior Windows	
B2020 102 Wood Windows	380
B2020 104 Steel Windows	381
B2020 106 Aluminum Windows	381
B2020 210 Tubular Aluminum Framing	382
B2020 220 Curtain Wall Panels	383
B2030 Exterior Doors	
B2030 110 Glazed Doors, Steel or Aluminum	384
B2030 210 Wood Doors	386
B2030 220 Steel Doors	386

Table of Contents

<i>Table No.</i>		<i>Page</i>
B2030 230	Aluminum Doors	387
B3010 Roof Coverings		
B3010 105	Built-Up	388
B3010 120	Single Ply Membrane	389
B3010 130	Preformed Metal Roofing	389
B3010 135	Formed Metal	389
B3010 140	Shingle & Tile	390
B3010 320	Roof Deck Rigid Insulation	391
B3010 420	Roof Edges	391
B3010 430	Flashing	392
B3010 610	Gutters	393
B3010 620	Downspouts	393
B3010 630	Gravel Stop	393
B3020 Roof Openings		
B3020 110	Skylights	394
B3020 210	Hatches	394
C INTERIORS		
C1010 Partitions		
C1010 102	Concrete Block Partitions - Regular Weight	396
C1010 104	Concrete Block Partitions - Lightweight	397
C1010 120	Tile Partitions	398
C1010 124	Drywall Partitions/Wood Stud Framing	399
C1010 126	Drywall Partitions/Metal Stud Framing	400
C1010 128	Drywall Components	401
C1010 140	Plaster Partitions/Metal Stud Framing	402
C1010 142	Plaster Partitions/Wood Stud Framing	403
C1010 144	Plaster Partition Components	404
C1010 205	Partitions	405
C1020 Interior Doors		
C1020 102	Special Doors	406
C1030 Fittings		
C1030 110	Toilet Partitions	407
C1030 310	Storage Specialties, EACH	408
C1030 510	Identifying/Visual Aid Specialties, EACH	408
C1030 520	Identifying/Visual Aid Specialties, S.F.	408
C1030 710	Bath and Toilet Accessories, EACH	408
C1030 730	Bath and Toilet Accessories, L.F.	408
C1030 830	Fabricated Cabinets & Counters, L.F.	408
C1030 910	Other Fittings, EACH	409
C2010 Stair Construction		
C2010 110	Stairs	410
C3010 Wall Finishes		
C3010 230	Paint & Covering	411
C3010 235	Paint Trim	412
C3020 Floor Finishes		
C3020 410	Tile & Covering	413
C3030 Ceiling Finishes		
C3030 105	Plaster Ceilings	415

<i>Table No.</i>		<i>Page</i>
C3030 110	Drywall Ceilings	415
C3030 140	Plaster Ceiling Components	416
C3030 210	Acoustical Ceilings	416
C3030 240	Acoustical Ceiling Components	417

D SERVICES

D1010 Elevators and Lifts

D1010 110	Hydraulic	420
D1010 140	Traction Geared Elevators	420
D1010 150	Traction Gearless Elevators	421

D2010 Plumbing Fixtures

D2010 110	Water Closet Systems	424
D2010 120	Water Closets, Group	424
D2010 210	Urinal Systems	424
D2010 310	Lavatory Systems	425
D2010 410	Kitchen Sink Systems	425
D2010 420	Laundry Sink Systems	426
D2010 430	Laboratory Sink Systems	426
D2010 440	Service Sink Systems	427
D2010 510	Bathtub Systems	428
D2010 610	Group Wash Fountain Systems	428
D2010 710	Shower Systems	429
D2010 810	Drinking Fountain Systems	429
D2010 820	Water Cooler Systems	430
D2010 920	Two Fixture Bathroom, Two Wall Plumbing	431
D2010 922	Two Fixture Bathroom, One Wall Plumbing	431
D2010 924	Three Fixture Bathroom, One Wall Plumbing	431
D2010 926	Three Fixture Bathroom, Two Wall Plumbing	431
D2010 928	Four Fixture Bathroom, Two Wall Plumbing	432
D2010 932	Five Fixture Bathroom, Two Wall Plumbing	432

D2020 Domestic Water Distribution

D2020 220	Gas Fired Water Heaters - Residential Systems	433
D2020 230	Oil Fired Water Heaters - Residential Systems	433
D2020 240	Electric Water Heaters - Commercial Systems	434
D2020 250	Gas Fired Water Heaters - Commercial Systems	434
D2020 260	Oil Fired Water Heaters - Commercial Systems	435

D2040 Rain Water Drainage

D2040 210	Roof Drain Systems	436
-----------	--------------------------	-----

D2090 Other Plumbing Systems

D2090 810	Piping - Installed - Unit Costs	437
-----------	---------------------------------------	-----

D3010 Energy Supply

D3010 510	Apartment Building Heating - Fin Tube Radiation	440
D3010 520	Commercial Building Heating - Fin Tube Radiation	440
D3010 530	Commercial Bldg. Heating - Terminal Unit Heaters	440

D3020 Heat Generating Systems

D3020 102	Small Heating Systems, Hydronic, Electric Boilers	441
D3020 104	Large Heating Systems, Hydronic, Electric Boilers	441
D3020 106	Boilers, Hot Water & Steam	442
D3020 108	Heating Systems, Unit Heaters	443

Table of Contents

<i>Table No.</i>	<i>Page</i>
D3020 110 Heating System, Fin Tube Radiation	444
D3030 Cooling Generating Systems	
D3030 110 Chilled Water, Air Cooled Condenser Systems	445
D3030 115 Chilled Water, Cooling Tower Systems	447
D3050 Terminal & Package Units	
D3050 150 Rooftop Single Zone Unit Systems	449
D3050 155 Rooftop Multizone Unit Systems	451
D3050 160 Self-contained, Water Cooled Unit Systems	453
D3050 165 Self-contained, Air Cooled Unit Systems	455
D3050 170 Split Systems With Air Cooled Condensing Units	457
D3090 Other HVAC Systems/Equip	
D3090 320 Garage Exhaust Systems	459
D4010 Sprinklers	
D4010 310 Dry Pipe Sprinkler Systems	462
D4010 350 Preaction Sprinkler Systems	464
D4010 370 Deluge Sprinkler Systems	466
D4010 390 Firecycle Sprinkler Systems	468
D4010 410 Wet Pipe Sprinkler Systems	470
D4020 Standpipes	
D4020 310 Wet Standpipe Risers, Class I	472
Wet Standpipe Risers, Class II	472
Wet Standpipe Risers, Class III	472
D4020 330 Dry Standpipe Risers, Class I	473
Dry Standpipe Risers, Class II	473
Dry Standpipe Risers, Class III	473
D4020 410 Fire Hose Equipment	474
D4090 Other Fire Protection Systems	
D4090 910 Fire Suppression Unit Components	475
D4090 920 FM200 Systems	475
D5010 Electrical Service/Distribution	
D5010 120 Overhead Electric Service, 3 Phase - 4 Wire	476
D5010 130 Underground Electric Service	477
D5010 230 Feeder Installation	478
D5010 240 Switchgear	479
D5010 250 Panelboard	480
D5020 Lighting and Branch Wiring	
D5020 110 Receptacle (by Wattage)	481
D5020 115 Receptacles, Floor	481
D5020 130 Wall Switch by Sq. Ft.	482
D5020 135 Miscellaneous Power	482
D5020 140 Central A. C. Power (by Wattage)	482
D5020 145 Motor Installation	483
D5020 155 Motor Feeder	484
D5020 210 Fluorescent Fixtures (by Wattage)	485
D5020 216 Incandescent Fixture (by Wattage)	485
D5020 226 H.I.D. Fixture, High Bay, 16' (by Wattage)	486
D5020 234 H.I.D. Fixture, High Bay, 30' (by Wattage)	486
D5020 238 H.I.D. Fixture, Low Bay, 8'-10' (by Wattage)	486
D5020 242 H.I.D. Fixture, Low Bay, 16' (by Wattage)	487

<i>Table No.</i>	<i>Page</i>
D5030 Communications and Security	
D5030 910 Communication & Alarm Systems	488
D5090 Other Electrical Systems	
D5090 210 Generators (by kW)	489

E EQUIPMENT & FURNISHINGS

E1010 Commercial Equipment	
E1010 110 Security/Vault, EACH	492
E1010 510 Mercantile Equipment, EACH	492
E1010 610 Laundry/Dry Cleaning, EACH	492
E1020 Institutional Equipment	
E1020 110 Ecclesiastical Equipment, EACH	493
E1020 130 Ecclesiastical Equipment, L.F.	493
E1020 210 Library Equipment, EACH	493
E1020 230 Library Equipment, L.F.	493
E1020 310 Theater and Stage Equipment, EACH	493
E1020 320 Theater and Stage Equipment, S.F.	493
E1020 330 Theater and Stage Equipment, L.F.	493
E1020 610 Detention Equipment, EACH	493
E1020 710 Laboratory Equipment, EACH	494
E1020 720 Laboratory Equipment, S.F.	494
E1020 730 Laboratory Equipment, L.F.	494
E1020 810 Medical Equipment, EACH	494
E1030 Vehicular Equipment	
E1030 110 Vehicular Service Equipment, EACH	495
E1030 210 Parking Control Equipment, EACH	495
E1030 310 Loading Dock Equipment, EACH	495
E1090 Other Equipment	
E1090 210 Solid Waste Handling Equipment, EACH	496
E1090 350 Food Service Equipment, EACH	496
E1090 360 Food Service Equipment, S.F.	496
E1090 410 Residential Equipment, EACH	496
E1090 610 School Equipment, EACH	496
E1090 620 School Equipment, S.F.	497
E1090 810 Athletic, Recreational, and Therapeutic Equipment, EACH	497
E1090 820 Athletic, Recreational, and Therapeutic Equipment, S.F.	497
E2010 Fixed Furnishings	
E2010 310 Window Treatment, EACH	498
E2010 320 Window Treatment, S.F.	498
E2010 420 Fixed Floor Grilles and Mats, S.F.	498
E2010 510 Fixed Multiple Seating, EACH	498
E2020 Moveable Furnishings	
E2020 210 Furnishings/EACH	499
E2020 220 Furniture and Accessories, L.F.	499
F SPECIAL CONSTRUCTION	
F1010 Special Structures	
F1010 120 Air-Supported Structures, S.F.	502
F1010 210 Pre-Engineered Structures, EACH	502

Table of Contents

<i>Table No.</i>	<i>Page</i>
F1010 320 Other Special Structures, S.F.	502
F1010 330 Special Structures, EACH	502
F1010 340 Special Structures, S.F.	502
F1020 Integrated Construction	
F1020 110 Integrated Construction, EACH	503
F1020 120 Integrated Construction, S.F.	503
F1020 250 Special Purpose Room, EACH	503
F1020 260 Special Purpose Room, S.F.	503
F1020 330 Special Construction, L.F.	503
F1030 Special Construction Systems	
F1030 120 Sound, Vibration, and Seismic Construction, S.F.	504
F1030 210 Radiation Protection, EACH	504
F1030 220 Radiation Protection, S.F.	504
F1030 910 Other Special Construction Systems, EACH	504
F1040 Special Facilities	
F1040 210 Ice Rinks, EACH	505
F1040 510 Liquid & Gas Storage Tanks, EACH	505
F1040 910 Special Construction, EACH	506

<i>Table No.</i>	<i>Page</i>
G BUILDING SITEWORK	
G1030 Site Earthwork	
G1030 805 Trenching Common Earth	508
G1030 806 Trenching Loam & Sandy Clay	508
G1030 807 Trenching Sand & Gravel	508
G1030 815 Pipe Bedding	510
G2010 Roadways	
G2010 232 Bituminous Roadways Crushed Stone	511
G2020 Parking Lots	
G2020 210 Parking Lots Gravel Base	513
G2040 Site Development	
G2040 810 Flagpoles	514
G2040 950 Other Site Development, EACH	514
G3030 Storm Sewer	
G3030 210 Manholes & Catch Basins	515
G4020 Site Lighting	
G4020 210 Light Pole (Installed)	516

Reference Section

All the reference information is in one section making it easy to find what you need to know . . . and easy to use the book on a daily basis. This section is visually identified by a vertical gray bar on the edge of pages.

In this Reference Section, we've included General Conditions; Location Factors for adjusting costs to the region you are in; Historical Cost Indexes for cost comparisons over time; a Glossary; an explanation of all Abbreviations used in the book; and sample Estimating Forms.

Table of Contents

General Conditions	518
Location Factors	519
Historical Cost Indexes	525
Square Foot Costs	533
Glossary	542
Abbreviations	546
Forms	550